

TELENCO® HYPOCUT FIBRE OPTIC DROP CLAMP

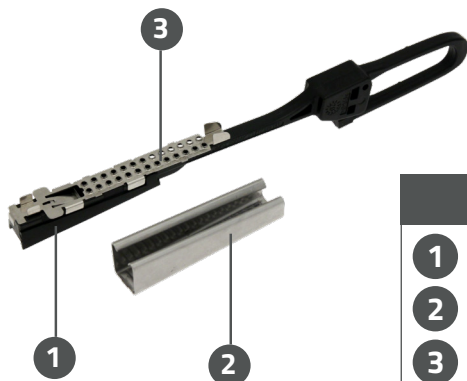

LEGEND	
1	Wedge & Bail
2	Body
3	Shim

Part of the Telenco® HYPOCLAMP family, the HYPOCUT clamp enables the anchoring of flat aerial drop cables where spans do not exceed 70m. This clamp consists of a stainless steel body, a shim with an embedded blade and a plastic wedge equipped with an integrated opening bail. For easy cable installation, the Telenco® HYPOCUT clamp is delivered in 2 parts.



PERFORMANCES

This clamp is fully compliant with the following international standards:

- NF EN C-20-540 Climatic ageing test
- NF EN 60068-2- 11 and ASTM B117 Corrosion test
- XP C93-850-3-25 §4.3.5 and §4.3.6 for tensile and aeolian test

FEATURES & BENEFITS

- Easy, quick and tool-less installation
- Opening bail for installation onto closed or opened hardware: cross-arms, hooks, brackets
- Installation without cable bending into the clamp

INSTALLATION

- On end poles
- When the line is at an angle greater than 25° in order to preserve the integrity of the cable over time
- If road crossing (mandatory cable stop on each pole on both sides of the road)
- In case of unbalanced adjacent spans (a span of 40m, followed by a span of 30m, for example)
- If rugged terrain (line mountainside down for example).
- In alignment, every 5 poles or on every pole



Simple anchoring



Double anchoring

CODE	MODEL	MAX. CABLE		MCL*	WEIGHT	PACKAGING
		MAX. WIDTH	MAX. HEIGHT			
92460	HYPOCUT	6mm	3.15mm	1350N-2000N	0.04kg	30 units

* Maximum or minimum cutting load: for the reference cable